

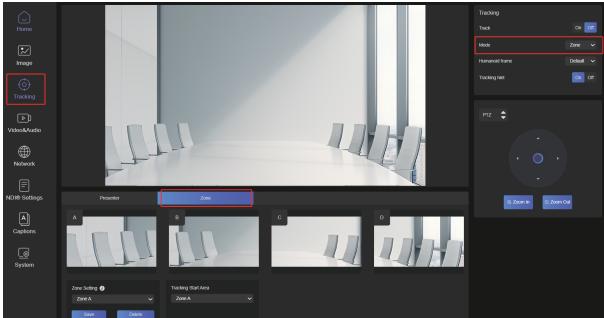

Setting procedures are as below:

Step 1: Tacking-Mode(Zone).



Step 2: Use the arrow keys and zoom keys on the WebUI to adjust the camera head's position, set multiple preset positions such as Zone A, and select "Save". Amount of preset positions depends on actual application needs. Currently, a maximum of 4 zones can be set. If the setting is wrong, it can be deleted or reset. The adjacent zones must overlap with each other and be arranged in sequence, but the serial letters assigned to name them may jump the alphabetical order (it can be C after A, not strictly B after C).

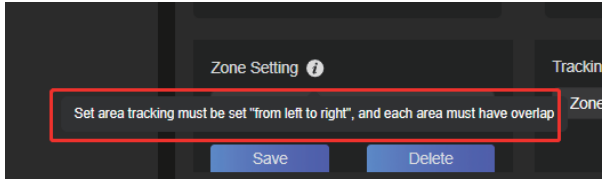

12

## 6. Common Operation Instructions

### 6.1 Camera Select

Set the IR remote control's address to control the corresponding camera, option item 1/2/3/4



### 6.2 Camera Direction Control

- Turning up
- Turning down
- Turning left
- Turning right
- Turning to default



Note: Press the direction key when you need to adjust the angle.

If you want to move the camera slowly, just click the direction key;

If you want to move the camera fast at a large scale, just long-press the button;

If you want to adjust the Pan-Tilt direction, just press and hold the L/R button for 10S.

### 6.3 Camera Focusing Mode Control

- [AUTO FOCUS] Switch the focus mode to AUTO
- [MANUAL FOCUS] Switch the focus mode to MANUAL
- [FAR] Far focus manually
- [NEAR] Near focus manually



### 6.4 Camera Zoom Control

Press any one of the 4 [ZOOM] to make the zoom functioning.

These 4 keys are not applicable for fixed focus cameras.



### 6.5 Preset Setup, Call, Cancel

(1) Reserve Preset: Press [PRESET] , then press one of the numbers (0-9) to reserve a preset that correspond to the NUMBER.

Note: You can setup 10 presets at most by the remote control.

(2) Call Preset: Press the NUMBER (0-9) directly to call the reserved preset.

Note: It won't work if there's no preset reserved in the corresponded number.

(3) Remove Preset: Press [RESET] , then press one of the number (0-9) to remove a preset that corresponds to the NUMBER.



14

### 6.8 RS-232 Interface Distribution



No.	Function	No.	Function
1	RTS	5	SD
2	TXD	6	SDS
4	TXD	8	NC

### 6.9 RS-485 Interface Distribution

Pin No.	Function
A	RTS (R) (connect to RS-485)
B	TXD (R) (connect to RS-485)

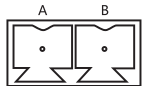

### 7.2 How to add networking:

7.2.1 Open the computer network local connection attribute window select "Internet Protocol Version 4 : TCP/IPv4;

7.2.2 Double-or-right-click "Internet Protocol Version 4 (TCP/IPv4);

7.2.3 Enter the Internet Protocol Version 4 (TCP/IPv4) window.

7.2.4 Change the computer's IP to 192.168.0.206 so that the computer IP and camera IP are on the same network segment.

PS: If no network segment is added, You will fail to login. The default IP address of the product is 192.168.0.206. "O"network segment needs to be added to the computer.

The IP address cannot conflict with the IP address of other computers or products. Before adding, please verify whether the IP already exists.

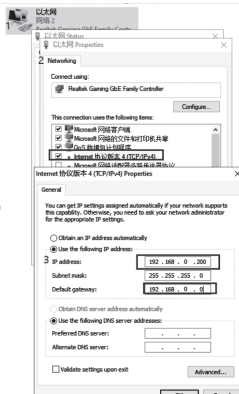

7.3 Input http://192.168.0.206 to IE (better with IE or Google web browser), a login window pop up, input user name: admin, password: admin, language: English, shown as below, whether the IP already exists.

7.3.1 When logging in for the first time, will be prompted to change your password.

Users can change the passwords and save it.

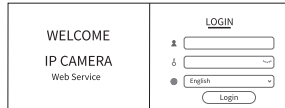

18

## 7. Network Function

### 7.1 Equipment installation

Connect HD video camera to your internet or your PC via network cable, or connect by Switch/Router.

You can log into the camera's web interface with the default or modified IP.

(Different models have different IP, please check the default IP at the bottom of the camera.)

7.1.1 How to query the IP address of your PC (Note the text in the box)

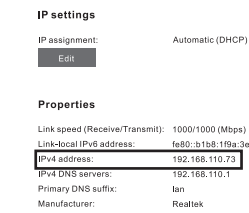
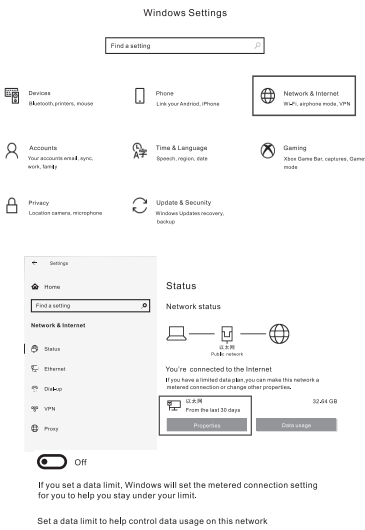

17

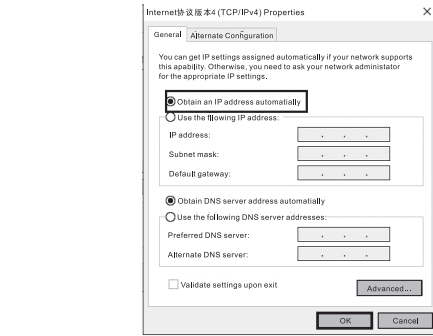

### 7.5 Video streaming

7.5.1 Select "Setup"- "Video Settings"- "System Settings" to enter the following interface:

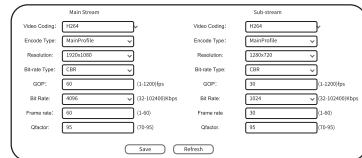

### 7.5.2 RTSP video streaming

Select "Setup"- "Network Settings"- "RTSP" to enter following interface:



20

## 8. Installation Instructions

### 8.1 Surface Installation

Put the camera on the desk flatly, and make sure the camera is in a horizontal position.

If you want to put the camera on an oblique surface, please make sure the angle of inclination is less than 15 degrees to ensure the camera pan and tilt work in normal operation.

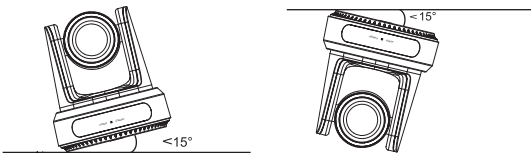

### 8.2 Wall Mount Installation

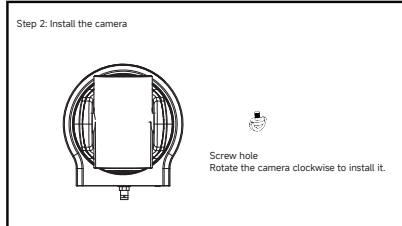
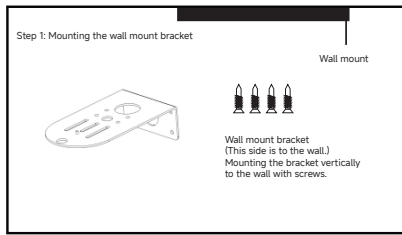

22

## 9. Trouble Shooting

Before requesting service to service engineer, please refer to the following methods to remove failures. If the failures still can't be solved, please contact us for assistance.

Q: The video of the camera cannot be displayed on the screen.

A: Please check the connection between power cable, video cable, camera and monitor, fix the connector on each end.

Q: It's unable to Pan, Tilt and Zoom camera.

A: Because the menu was displayed on monitor. Please re-operate after exiting the menu

Q: Why the camera rotates for about 10 seconds after power on?

A: This is the normal self-test of the camera

Q: Poor Image quality while using in church or other low-light conditions.

A: Press menu (ON/OFF) to adjust backlight effect to suit the church lighting properly.

Q: Remote control is not working or insensitive.

A: ①Not work, please replace batteries

②Not sensitive: Choose the correct "IR select" number to correspond to the camera.

Control the camera within 10m (32.8ft). Remove the obstacles. Aim at the sensor

which is in front of the camera when controlling it.

Q: USB interface is not identifiable.

A: Please check if the USB cable and extension cable are well connected or not. If yes,

change to another USB interface and try to connect again.

Q: It won't be controlled via RS-232/RS-485 when camera connect to PC.

A: Make sure it is a correct connection between the camera and PC.(Reference to RS-485 and RS-232 Pins distribution on page 16).

Q: Why no ceiling mount bracket?

A: Camera comes with wall mount, ceiling mount or tripod brackets need to buy separately.

Q: Does this camera has built-in mic?

A: No, this camera comes with no built-in mic.

Q: Can we control the camera only by the remote control?

A: You can control the camera by remote control, keyboard controller (joystick), and software.

13

15

19

21

23